



ACCESSORIES

# Wardrobe

www.flatpax.com.au

## Rotating Pull Out Mirror

(To suit 450mm & 900mm Wardrobe Cabinets)

16mm Screws x 6

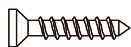

28mm Screws x 4



Plastic Lugs x 4



### IMPORTANT INFORMATION

Please read prior to installing the Rotating Pull Out Mirror.

For maximum functionality of the mirror we recommend the following:

- Avoid installing mirror to the wardrobe cabinet side panel where door hinges are attached, as the hinged doors may block the sliding ability of the mirror.
- If you require full rotation of the mirror, allow for clearance between the mirror and walls beside the wardrobe.
- Consider the positioning of sliding doors, as in some cases these may prevent full rotation of the mirror.

### STEP 1 INSERTING PLASTIC LUGS

Side Panel

Back Panel

Side Panel

Locate your desired side panel and height, then insert the top set of plastic lugs into the holes you intend to use.

Count 35 holes down and then insert the bottom set of plastic lugs.

35mm holes

### STEP 2 ATTACHING FIXING RAILS

Side Panel

Back Panel

Sits flush

Front of cabinet

Attach the top fixing rail to the side panel through the plastic lugs using the 28mm screws provided, making sure that the front of the fixing rail is flush with the cabinet.

Side Panel

Back Panel

Side Panel

Sits flush

Front of cabinet

35mm hole

Repeat the same process to attach the bottom fixing rail.



**CAUTION !** Please ensure all cabinets are screwed into your timber stud wall using a minimum of 8 gauge, 65mm screws. If attaching to concrete, brick, steel or other sub surfaces seek advice from your hardware specialist. Please ensure you follow the installation and safety instructions located on your cabinet assembly instructions carefully.

For further enquiries visit [www.flatpax.com.au](http://www.flatpax.com.au) or call customer service on 1800 666 078  
Between 7:00am - 6:30pm E.S.T Mon - Fri

Ver 1.7

## Rotating Pull Out Mirror

(To suit 450mm & 900mm Wardrobe Cabinets)

### STEP 3

#### ATTACHING RUNNERS

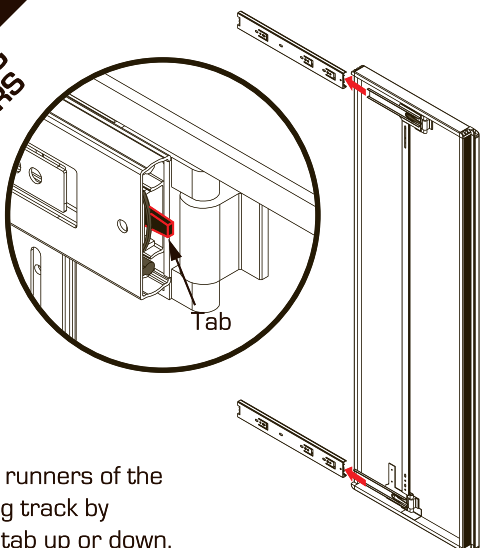

Remove the runners of the mirror sliding track by pushing the tab up or down.

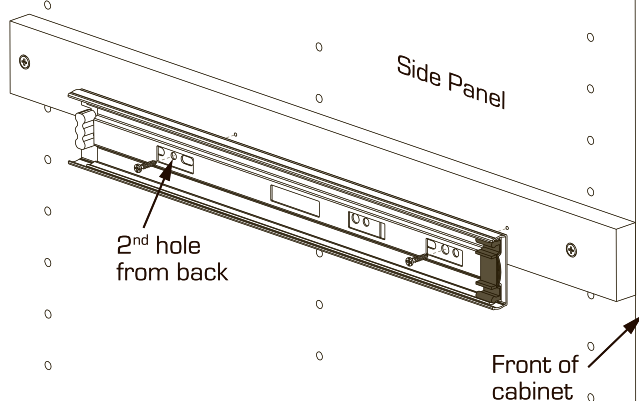

Attach the top runner to the top fixing rail through the pilot holes with the screws provided.

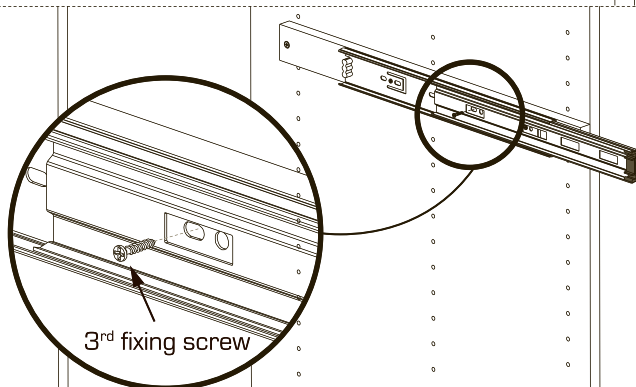

For added strength fix a third screw through runner. Repeat the same process for the bottom runner.

### STEP 4

#### ATTACHING MIRROR TO RUNNERS

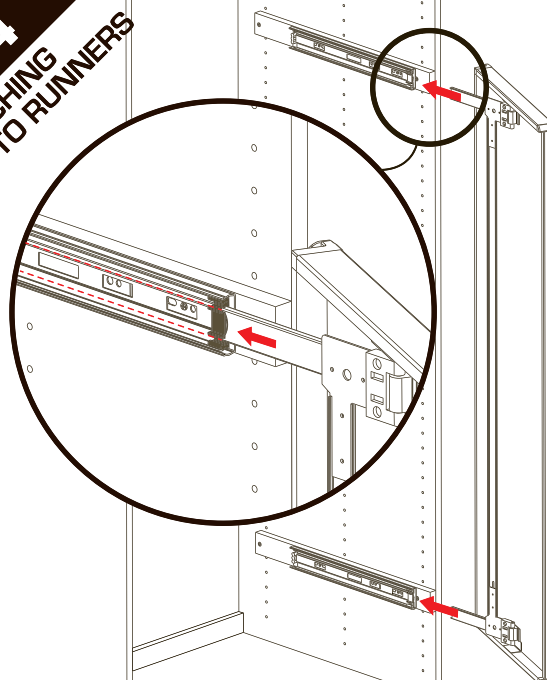

Insert the mirror into the runners and slide forward to complete installation

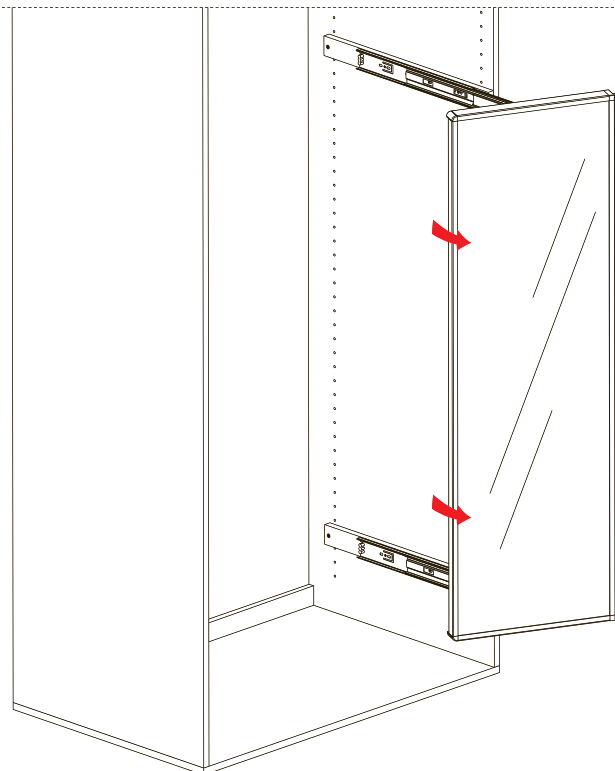

For usage pull out mirror and rotate each way.