

450mm Slide Out Trouser Rack

16mm Screws x 16



28mm Screws x 8



Plastic Lugs x 8



STEP 1 INSERTING PLASTIC LUGS

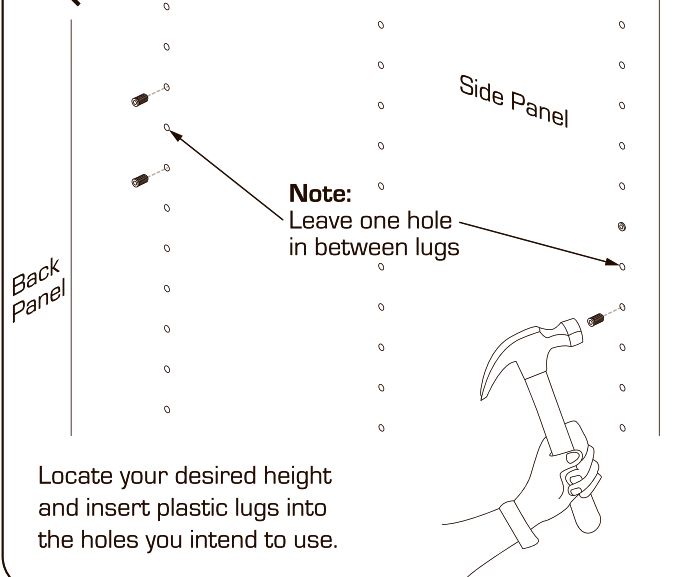

STEP 2 ATTACHING FIXING RAILS

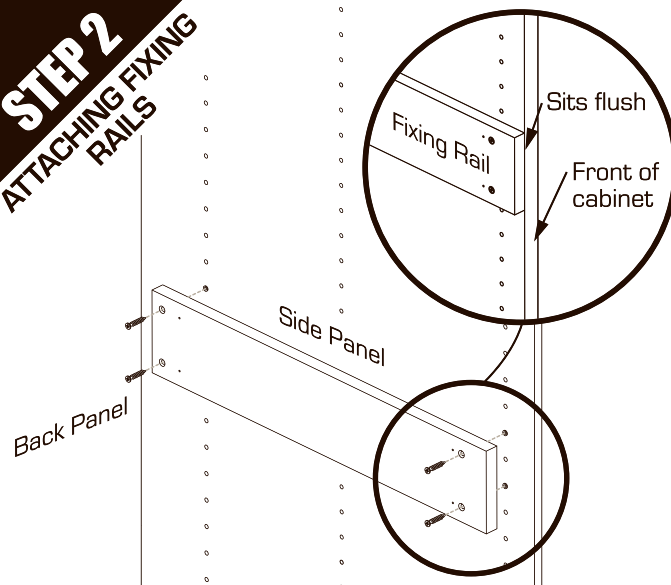

Attach the fixing rail to the side panel through the plastic lugs using the 28mm screws provided, making sure that the front of the fixing rail is flush with the cabinet. Repeat the same process to attach the other fixing rail on the other side panel.

STEP 3 ATTACHING TROUSER RACK

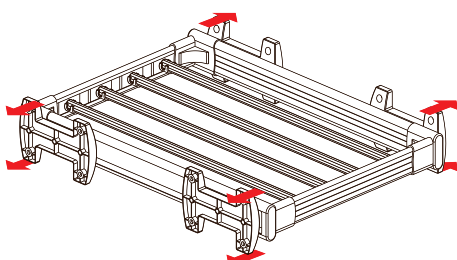
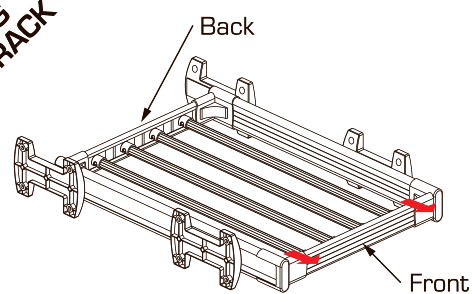

Adjust the width of the trouser rack to suit by extending or reducing the frames.

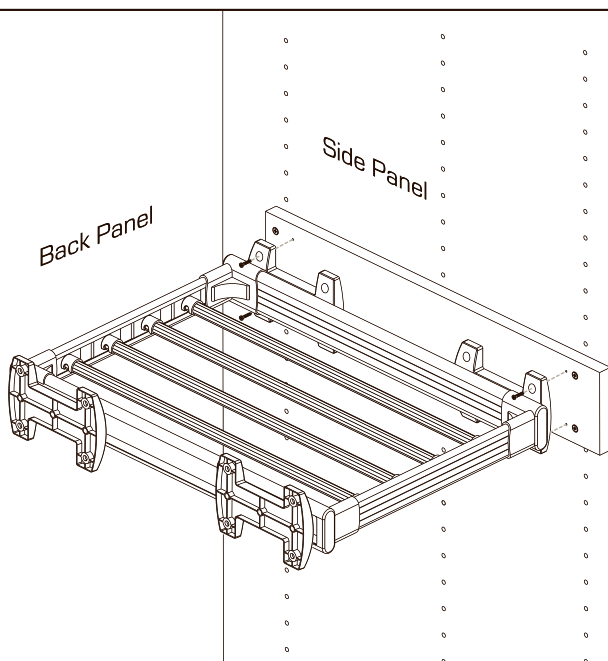

Align the front top and bottom holes of the front bracket and the rear top and bottom holes on the rear bracket with the pilot holes on the fixing rail and attach with 16mm screws.

STEP 4
ATTACHING
TROUSER RACK

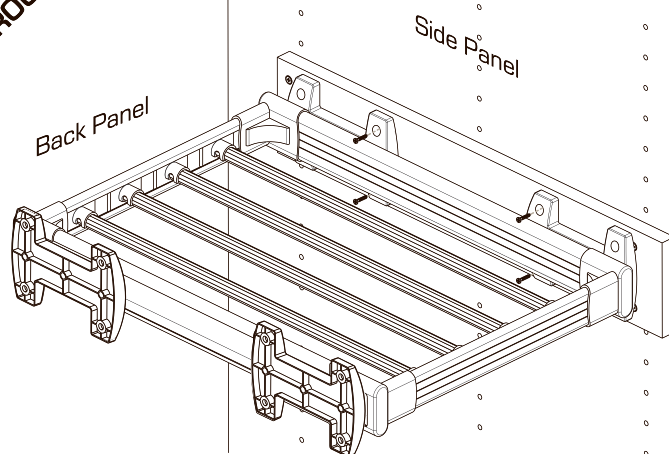

Then fix the remaining holes in both brackets to the fixing rail with 16mm screws.

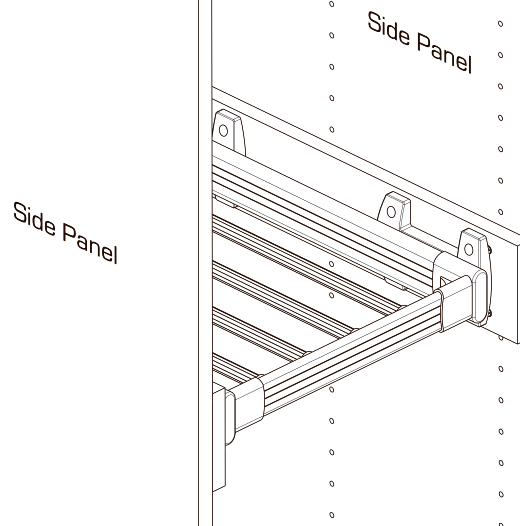

Repeat the same process for the other side panel.



CAUTION ! Please ensure all cabinets are screwed into your timber stud wall using a minimum of 8 gauge, 65mm screws. If attaching to concrete, brick, steel or other sub surfaces seek advice from your hardware specialist. Please ensure you follow the installation and safety instructions located on your cabinet assembly instructions carefully.

For further enquiries visit www.flatpax.com.au or call customer service on 1800 666 078
Between 7:00am - 6:30pm E.S.T Mon - Fri